



Aboriginal Medical Services  
Alliance Northern Territory

# CERVICAL SCREENING – self collection

Barb Molanus

Sexual Health Coordinator – AMSANT

0439 827 160

# Easier and worser

Cervical screening has just got a whole lot easier

BUT...

Screening rates in the NT are declining

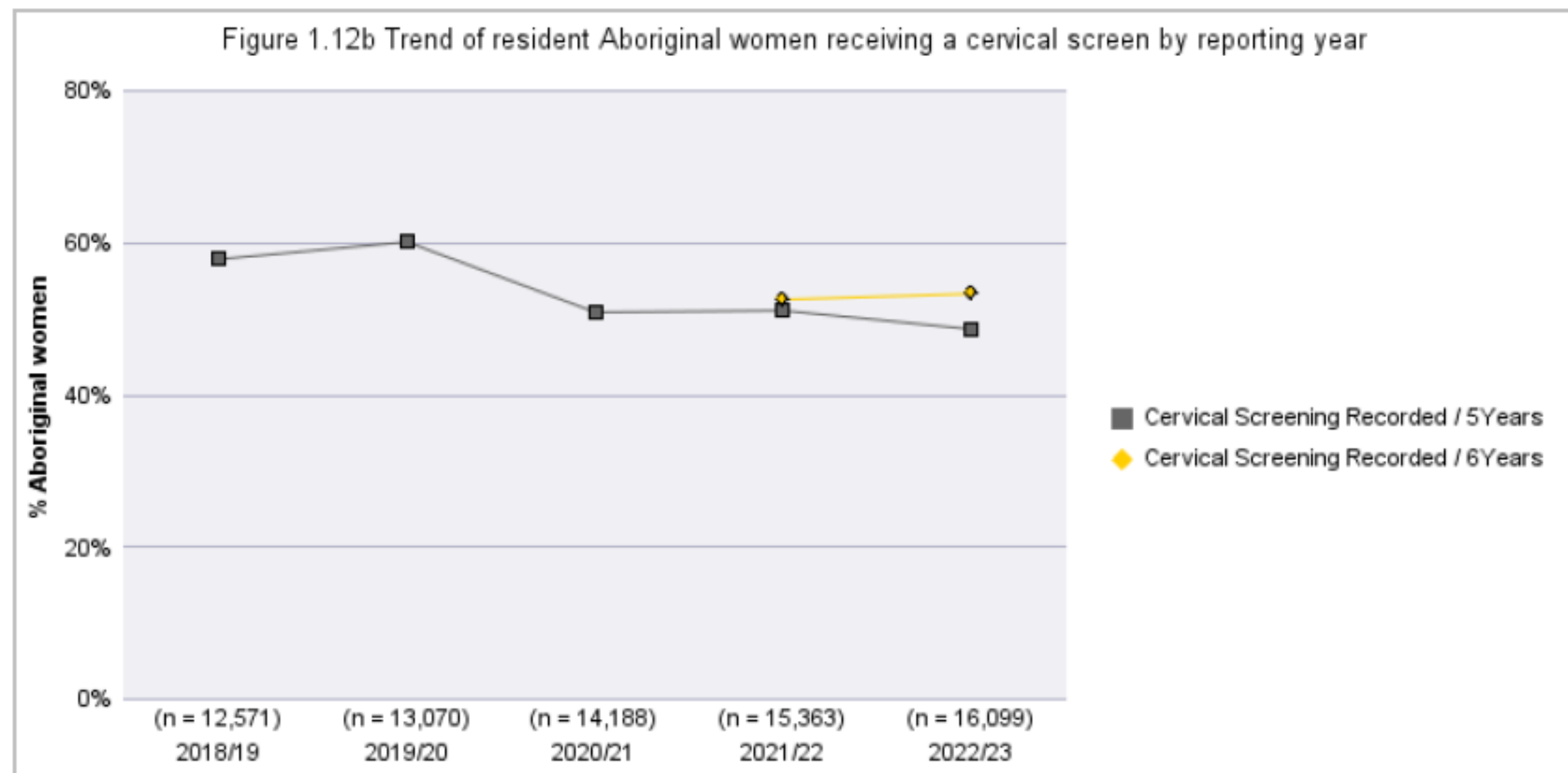

Why?



# There Are 2 Types of Cervical Screening Tests (CSTs)

Test the cervical cells AND for the HPV virus

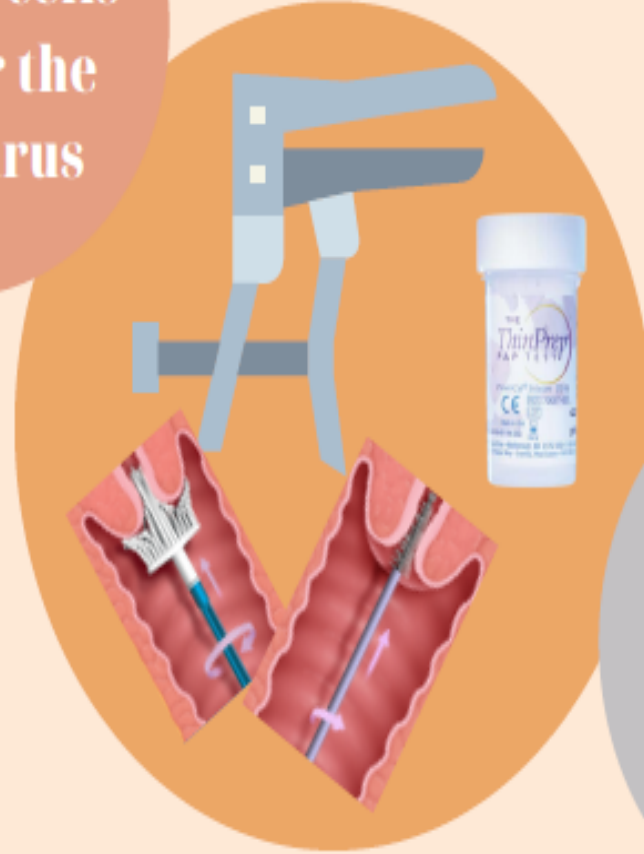

Must be done by a certified health care professional

## Clinician Collected

- A person who has had a HPV positive result on a self-collect CST.
- A person who has had a previous abnormal cervical screening results and not completed the required follow-up.
- A person with abnormal PV bleeding.
- A person with symptoms of cervical cancer such as pelvic pain, abnormal PV discharge, pain during sexual intercourse.

Tests for the HPV virus ONLY.



Any health care professional can inform a person how to do the self-collect the test on their own

## Self Collected

- Any person with a cervix aged 25-74 who has never had a cervical screening test before.
- Any person who has a previous HPV negative or low risk cervical screening test on routine follow up.
- Self-collected can be considered in cases where a person meets the criteria for clinician collected but has declined and is overdue.
- Pregnant people can attend at anytime.



# How do I know if a client requires a Cervical Screening Test if I can't find any information in PCIS?

NATIONAL  
CANCER  
SCREENING  
REGISTER

To get results or advice you can call  
**1800 627 701**  
the cancer screening hotline!

You will need a doctors provider number to access results however you can apply for your own nursing number to use too!

You can also access results online through PRODA by linking your account with a clinic or doctor.

Click on the logos to take you to the websites!

NATIONAL  
CERVICAL SCREENING  
PROGRAM

A joint Australian, State and Territory Government Program

The screenshot shows the 'Participant Search' page of the National Cancer Screening Register. At the top, there are navigation links: 'Participant' (highlighted), 'My Profile', 'My Correspondence', and 'iFOBT Bulk Order'. Below the navigation bar, the 'Participant Search' section includes a note: 'All fields are required unless participant has one name only'. The search form contains several input fields: 'Identifier Type' (a dropdown menu with 'Medicare' selected), 'Medicare Number' (a text box), 'Family Name' (a text box), 'Given Name' (a text box), 'Sex' (a dropdown menu), and 'Date Of Birth' (a date picker with the example 'eg 06-Dec-1982'). At the bottom of the form are two buttons: 'Search' and 'Reset'.

PRODA

Provider Digital Access



# Cervical Screening as easy as 1, 2, 3!

## Cervical Screening (HPV) Self Collection Swab Processing



A guide for Healthcare Practitioners using Western Diagnostic Pathology.

### 1 OFFER HPV SELF COLLECTION SWAB EVERY 5 YEARS TO ALL PEOPLE WITH A CERVIX WHO;

- Are aged 25-74.
- Have had any type of sexual contact.

Self collection is generally not appropriate for people who have had previous abnormal cervical screening results or symptoms of cervical cancer. If they are experiencing unusual bleeding, discharge, painful sex or pelvic pain than a traditional cervical screening test (with a speculum) should be offered and attended.

### 2 ENSURE YOU HAVE A RED TOP FLOQ COPAN SWAB WITH THE CODE 552C.80. THIS SWAB CAN BE GIVEN TO THE PATIENT TO ATTEND IN PRIVATE.



How self collect is attended (instructions):

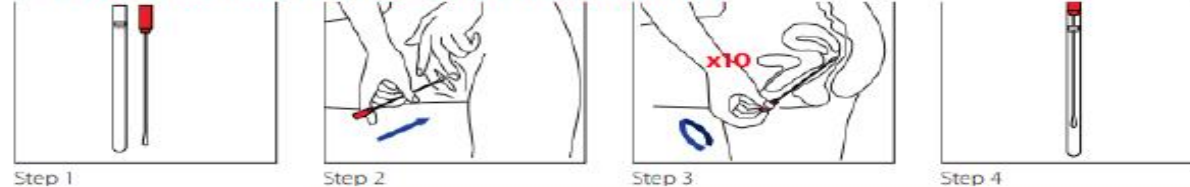

### 3

ONCE YOU HAVE RECEIVED THE SWAB TAKE THE RED CAP OFF AND IMMERSE IT IN THE THINPREP® LIQUID. DUE TO HOW WESTERN PROCESS THIS TEST - IT WILL NOT BE ACCEPTED WITHOUT THE CORRECT FLOQ SWAB AND THINPREP® VIAL.

- Take ThinPrep® lid off after checking expiry date.
- Immerse swab tip fully into ThinPrep® and swirl for 20 seconds.
- Hold the tip against inner wall to drain fluid from swab into the vial.
- Remove and Recap FLOQ swab and ThinPrep® vile.
- Record patients name & date of birth clearly on ThinPrep® vile.
- Place the FLOQ swab + ThinPrep® vile in GREEN pathology bag (if available).

- Ensure **TESTS REQUESTED** SELF COLLECTION, CERVICAL SCREENING TEST is clearly identified on request form.

#### MATERIALS REQUIRED

- Pathology Request Form
- COPAN FLOQ Swab
- ThinPrep Vial
- Self Collect Instructions

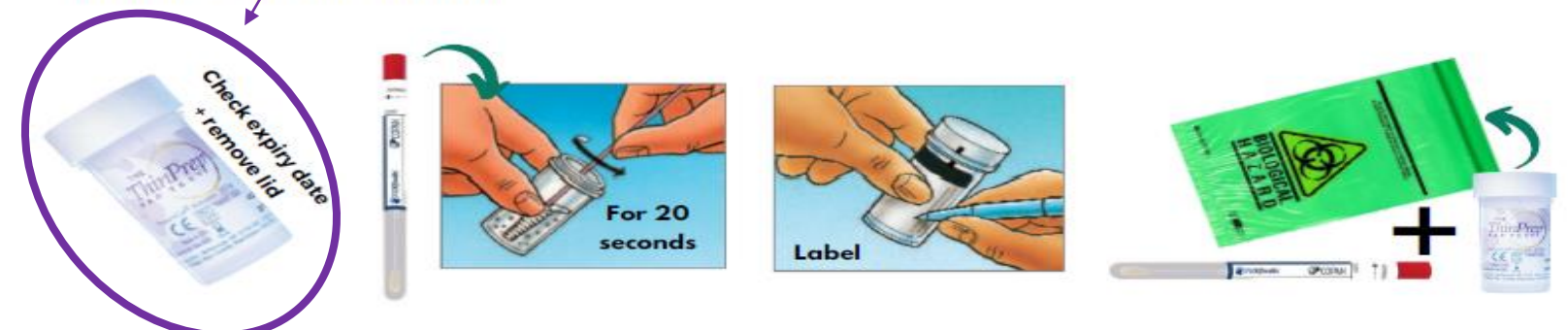

You can order all materials required as a complete 'Cervical Screening Self Collection Kit - For HPV Testing' directly from Western Diagnostic Pathology using the PHC Remote CAHS Form. Hand write this under the cytology/gynaecological heading at the bottom until a updated form is released.

FLOQ Swabs (Red top - for self-collected HPV testing)	Each	
Cervical Screening Test Self Collection Kits - for HPV Testing	Each	
STATIONERY		

Swab only!!





## NATIONAL CERVICAL SCREENING PROGRAM

A joint Australian, State and Territory Government Program



Understanding the National Cervical Screening Program Management Pathway:  
A Guide for Healthcare Providers



Australian Government

Australian Government  
Department of Health and Aged Care

Home Topics Initiatives and programs Resources

Home > Initiatives and programs

### National Cervical Screening Program – Healthcare provider toolkit

This toolkit helps healthcare providers engage under-screened and never-screened women in cervical screening, and support them if they choose to participate.

**Understanding barriers to screening**  
Learn about barriers to cervical screening for your patients.

**Demonstrating respect and building trust**  
Learn strategies to engage patients in cervical screening.

**Cervical screening options**  
Learn about screening options, including self and clinician collection of samples.

**Resource library**  
Discover the full list of resources available to support healthcare providers.

[View all toolkit information >](#)

#### About the toolkit

More than 70% of Australian women who develop cervical cancer have never had cervical screening, and/or not regularly. This toolkit contains resources and information to help healthcare providers engage their patients and support them to participate in cervical screening.

## NATIONAL CERVICAL SCREENING PROGRAM

A joint Australian, State and Territory Government Program

# Resources

NATIONAL  
CANCER  
SCREENING  
REGISTER

1800 627 701

ALL THE RESOURCES ARE CLICKABLE LINKS!  
CLICK THEM TO TAKE YOU TO THE WEBSITES!

### Online training – CPD points

To assist you to understand the NCSP and the important role of self-collection, the Department and NPS MedicineWise have developed online training modules which are accredited for CPD points with RACGP, ACRRM, ACN, ACM and APNA.

These online training modules cover information about cervical screening and screening options available to patients (i.e. clinician-collection or self-collection), and the clinical management recommendations that support the Cervical Screening Test from the NCSP Clinical Guidelines, including:

- understanding the screening options available for Cervical Screening Tests
- collecting a Cervical Screening Test sample
- explaining how to take a self-collected vaginal sample
- understanding the risk categories and pathways
- practical advice and videos to help you engage with patients of Aboriginal and/or Torres Strait Islander or culturally and linguistically diverse backgrounds and patients with a disability.

The National Cervical Screening Program training is available at [learn.nps.org.au](https://learn.nps.org.au)



Australian Government  
NATIONAL CERVICAL SCREENING PROGRAM  
A joint Australian, State and Territory Government Program

### Cervical Screening Test – how to collect your own sample

Self-collection is one way you can choose to do your Cervical Screening Test every 5 years. It involves collecting your own sample from your vagina, in a private space. These instructions help you to collect your own sample, so you can prevent cervical cancer and live long and strong for yourself and your family.

1. Your doctor or nurse will give you a self-collection pack and a private space to do your test in. They'll explain how to do the test and will stay close by in case you need help.
2. Before you open it, take a look at the seal. It has one end for holding. The other is to collect the sample.
3. Make sure you are in a comfortable position and your underwear is lowered.
4. Hold the cap and take the wand out of the packaging. Be sure not to touch the end that will take the sample.
5. Insert the wand into your vagina, a few centimetres. The wand has a line of marks to show you how far to insert.
6. Move the wand gently in a circle and in any direction, for 10 to 30 seconds. It might feel uncomfortable, but shouldn't hurt. If it does, tell your doctor or nurse.
7. Remove the wand and put it back in the packaging.
8. If you think you have made a mistake, talk to your doctor or nurse and they can give you another self-collection pack.
9. Close the package and get dressed.
10. Give the packaging back to your doctor or nurse. After some time you may be asked your results.

If you have any questions or think you've made a mistake, talk to your doctor or nurse.

For more information about cervical screening:

- visit [health.gov.au/NCSP](https://health.gov.au/NCSP) or call 1800 627 701
- call 1800 627 701

Australian Government  
NATIONAL CERVICAL SCREENING PROGRAM  
A joint Australian, State and Territory Government Program

### Cervical Screening Test

Talk to your doctor or nurse today – for yourself, your family and your community.

Cervical screening is a simple test every 5 years that can help you stay healthy.

You can choose to screen by:

- collecting your own sample (self-collection) or
- having a doctor or nurse collect your sample.

Both ways test for a virus that can lead to cervical cancer.

Book an appointment with your doctor or nurse to talk about the best option for you.

Find out more [www.health.gov.au/NCSP](https://www.health.gov.au/NCSP) or call 1800 627 701.



Online course

#### National Cervical Screening Program

This series of six modules provides training for healthcare providers who conduct cervical screening tests and follow-up management for women aged 25–74. You can take the full course or choose any of the individual modules.





## Understanding your test result

These are the possible test results you can get and what they mean.

<b>Return to screen in 5 years</b>	<p>No HPV was found in your sample.</p> <p>Your next test is in 5 years. You'll be reminded 3 months before your next test is due.</p>
<b>Return for another sample collected by your healthcare provider</b>	<p>You chose self-collection for your test and HPV was found in your self-collected sample.</p> <p>You'll be asked to go back to your doctor or nurse. They will collect another sample that includes cervical cells. It's not possible to use self-collection for this sample.</p>
<b>Repeat the test in 12 months</b>	<p>HPV was found in your sample, but your body will probably clear it on its own. It's safe for you to wait 12 months before you test again.</p>
<b>Repeat the Cervical Screening Test due to unsatisfactory test result</b>	<p>The laboratory couldn't get a result from your sample. This doesn't mean there's something wrong.</p> <p>Book in to do your test again in 6 to 12 weeks.</p>
<b>Refer to a specialist</b>	<p>HPV was found in your sample and the type of HPV infection needs extra tests or treatment.</p> <p>Your doctor or nurse will refer you to a specialist for another test.</p>

# CST – too easy!!

